

RELAVIT

SOAK CL

Chlorinated dishwash liquid

RELAVIT SOAK CL is a fast acting cleaner, designed for use in busy cafes to remove tannin and coffee stains from cups and saucers. RELAVIT SOAK CL will also remove food debris from crockery and cutlery when used in machine dishwashers.

Do NOT use on aluminium, zinc or other alloys.

METHOD OF USE - Dishwashing

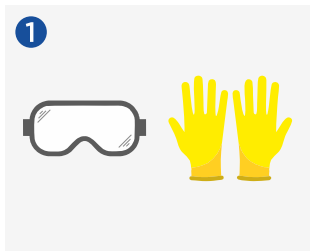

1 Wear correct PPE when changing dishwashing tubes.



2 Place the dosing tube into the container of Relavit Soak CL.



3 Run the dishwasher cycle to ensure the product is pulling through.

DOSAGE

DISHWASHER MACHINE

1-5mls per litre of water.

PRODUCT INFO



Pack Size:	5L, 20L
Product Code:	368
Odour:	Characteristic
Colour:	Light yellow
pH (undiluted):	13 - 14
Shelf life:	6 months



For Health & Safety information, please scan the QR code provided.

THINK SAFE, CLEAN GREEN

Christeyns Professional Hygiene UK Ltd | Clover House | Whaley Bridge
SK23 7DQ | T +44 (0) 1663 733 114 | W www.christeyns-ph.co.uk

CHRISTEYNS
PROFESSIONAL HYGIENE

RELAVIT

SOAK CL

Chlorinated dishwash liquid

RELAVIT SOAK CL is a fast acting cleaner, designed for use in busy cafes to remove tannin and coffee stains from cups and saucers. RELAVIT SOAK CL will also remove food debris from crockery and cutlery when used in machine dishwashers.

Do NOT use on aluminium, zinc or other alloys.

METHOD OF USE - Soaking

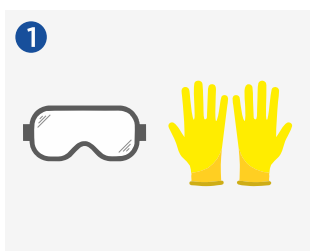

1 Wear correct PPE when changing dishwashing tubes.

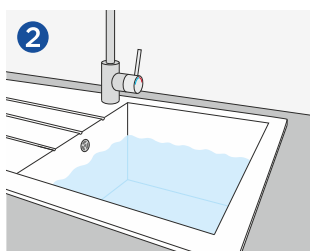

2 Fill a sink or bowl with hot or cold water and combine with Relavit Soak CL.



3 Pour Relavit Soak CL into a measuring jug using a tap and add to the sink.

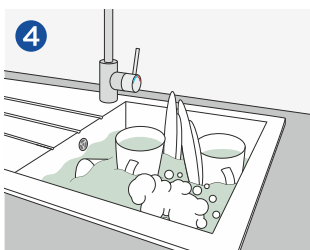

4 Add cutlery/crockery to the sink and allow to soak in the solution.

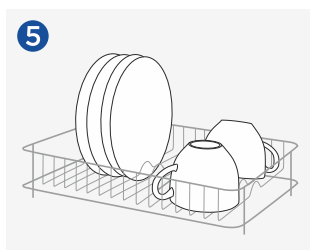

5 Rinse with clean water and allow to dry.

DOSAGE

SOAKING

5mls per litre of water

PRODUCT INFO



Pack Size:	5L, 20L
Product Code:	368
Odour:	Characteristic
Colour:	Light yellow
pH (undiluted):	13 - 14
Shelf life:	6 months



For Health & Safety information, please scan the QR code provided.

THINK SAFE, CLEAN GREEN

Christeyns Professional Hygiene UK Ltd | Clover House | Whaley Bridge
SK23 7DQ | T +44 (0) 1663 733 114 | W www.christeyns-ph.co.uk

CHRISTEYNS
PROFESSIONAL HYGIENE



KITCHEN
HYGIENE

RELAVIT SOAK CL

CHLORINATED DISHWASH LIQUID



- FAST ACTING FORMULA
- REMOVES TANNIN & COFFEE STAINS
- USE WITH HOT OR COLD WATER

PRODUCT DESCRIPTION

RELAVIT SOAK CL is a fast acting cleaner, designed for use in busy cafes to remove tannin and coffee stains from cups and saucers. RELAVIT SOAK CL will also remove food debris from crockery and cutlery when used in machine dishwashers.

A clear, chlorinated detergent, RELAVIT SOAK CL is suitable for use with hot or cold water in automatic dishwashing machines. Can also be used to soak stained cutlery/crockery until the stains have been removed.

INSTRUCTIONS FOR USE

MACHINE USE

Put the dosing tube into the container of RELAVIT SOAK CL so that it reaches the bottom. The dosing unit, which has been preset to a specific concentration, will automatically dispense RELAVIT SOAK CL into the machine. Adjust the charge on the dosing unit if necessary to gain the level of cleaning action required.

SOAK

Make up a solution of RELAVIT SOAK CL in a sink or bowl. Soak stained cutlery/crockery until the stains have gone and then rinse thorough with clean water.

N.B. Do NOT use on Aluminium, Zinc or other alloys.

ADDITIONAL INFORMATION

pH Level: 13-14

STORAGE

Use above 5°C. Store preferably above 0°C.

PACKAGING

Jerry Can	5 Litre
Container	20 Litre

NON WARRANTY

This information is based on our current knowledge and is intended to describe the product for the purposes of health, safety and environmental requirements only. It should not therefore be construed as guaranteeing any specific property of the product.